

#10-32 SHUTTLE VALVES



Shuttle Valves

There are three models of shuttle valves offered by Clippard. These valves feature a shuttle that allows flow from one inlet to the outlet while blocking the other inlet. They may be mounted directly to valves and cylinders or inline using the hose barbs on the MSV models.

Poppet type shuttle (double check) valve.
Brass body, and poppet, Buna-N seal



Medium: Air, Water or Oil

Input Pressure: 250 psig/17.5 bar max.

Air Flow: 5.0 SCFM @ 50 psig; 9.5 SCFM @ 100 psig; 230 l/min @ 6 bar

Mounting: Direct or inline

Operation: Flow from "A" to "C" or "B" to "C"

Pressure to Shift: 1/2 psig approx.

Exhaust: Through port where pressure was last applied

Note: Shuttle valves should not be used as a pressure selector



Part No.
MSV-1
MSV-1-M5

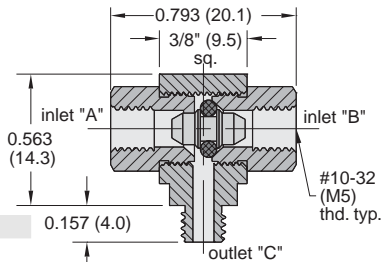

Part No.
MSV-1M22

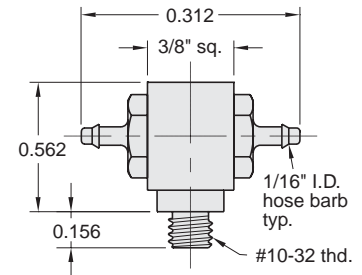

Part No.
MSV-1M44

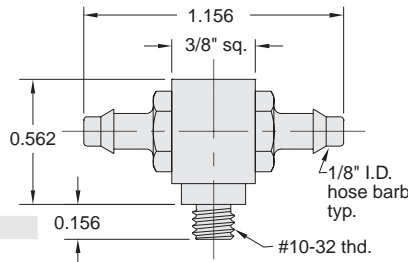

Part No.
MSV-1FFF

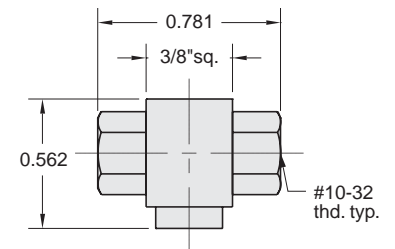

Part No.
MSV-1F22

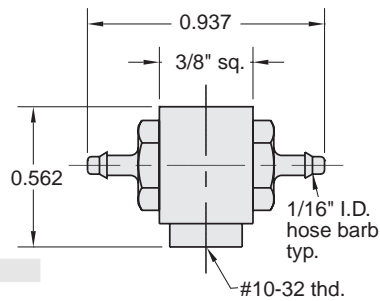

Part No.
MSV-1F44

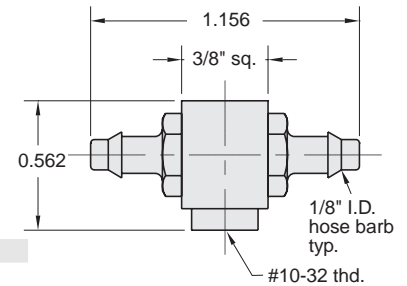

Part No.
MSV-1222

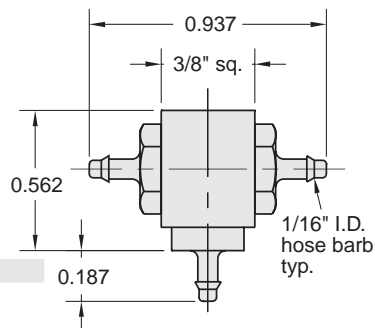

Part No.
MSV-1444

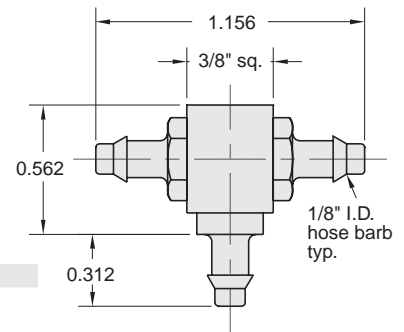



SHUTTLE VALVES

Poppet Type Shuttle Valves



Brass body, Delrin Poppet, Buna-N seal

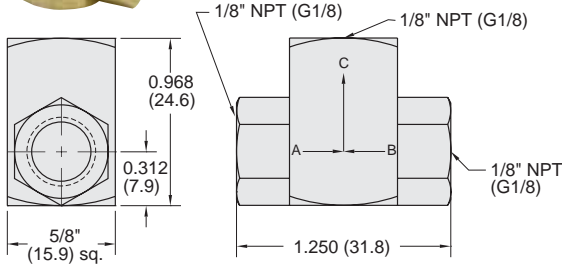

Medium: Air, Water or Oil

Input Pressure: 300 psig/21 bar - air; 1000 psig/70 bar - hydraulic

Air Flow: 14 SCFM @ 50 psig; 26 SCFM @ 100 psig; 630 l/min @ 6 bar

Mounting: Direct or inline

Operation: Flow from "A" to "C" or "B" to "C"

Pressure to Shift: 1/2 psig approx.



Note: Shuttle valves should not be used as a pressure selector

Part No. Description

MJSV-1 Poppet Shuttle Valve, 1/8" NPT

MJSV-1-MG . Poppet Shuttle Valve, G1/8

J-Series Shuttle Valves



Part No.
JSV-2FPF

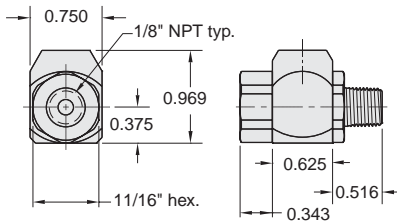

Poppet type shuttle (double check) valve. Brass body, stainless steel shuttle, Buna-N seal

Medium: Air, Water or Oil

Input Pressure: 300 psig max.

Air Flow: 30 SCFM @ 50 psig
50 SCFM @ 100 psig

Mounting: Direct or inline

Pressure to Shift: 1 psig approx.



Part No.
JSV-2PFF

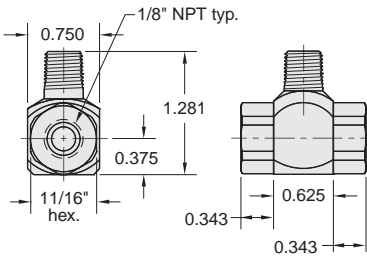

Part No.
JSV-2WFF

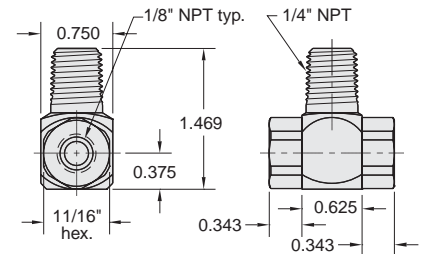

Part No.
JSV-2WYY

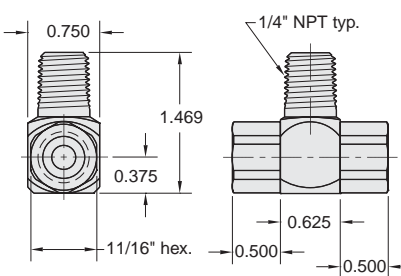

Part No.
JSV-2YFF

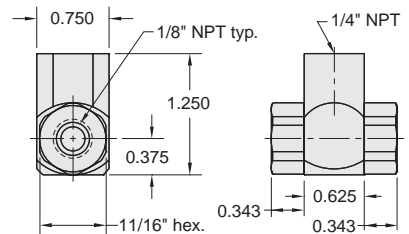

Part No.
JSV-2YYW

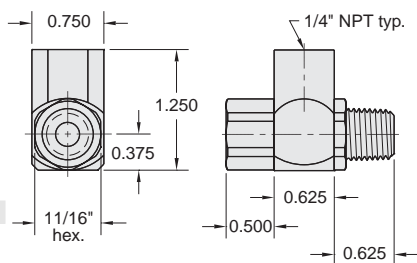

Part No.
JSV-2YYY

